

APARTMENT I

2 BDRM

1,236 SQ FT

2ND FLOOR

Upon entrance, all attention goes to the spectacular three-panel, patio door set leading to

a private balcony. An expansive open living area is enhanced by soaring cathedral ceilings and a striking gas fireplace in the corner. The gourmet kitchen features a grand, eat-at granite island and large pantry. The first bedroom boasts a vaulted ceiling, oversized windows, a walk-in closet, and bathroom with a tub/shower combination access across the hall. The spacious master bedroom is highlighted by two walls of perfectly placed

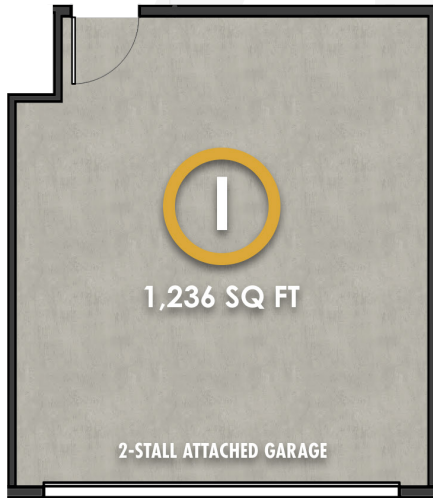

oversized windows and a walk-in closet. The master bathroom offers a double vanity divided by a window welcoming natural light as well as a shower with a bench seat. Two closets, one for storage and the other housing a full-sized washer and dryer are just off of the angled entry. The apartment features beautiful, durable hardwood-style floors throughout. Park in a private, attached two-car garage and enter through a secure foyer and stairwell shared with just one other neighbor.

2 BEDROOM

2 BATH

GAS FIREPLACE

2-STALL ATTACHED GARAGE

\$ _____ MOVE-IN _____